

# STORM-PRO-HR

## Low-Profile Hurricane Rated Lite Kit

For 1 3/4" Doors Florida Building Code #FL47124

### Windstorm Rated

Design Pressure = +/- 75 PSF  
Missile level "D" and includes  
Wind Zone 4 as defined in ASTM  
E 1996 and FBC Sections 1609.1.2.2  
& R301.2.1.2.1.

Meets the water infiltration  
requirements for the "HVHZ."  
Maximum Size 30" x 64"  
Hazard - Hurricane

This Product is Not Rated for Use  
on Fire-Rated Doors

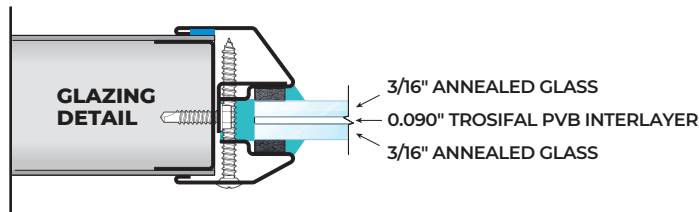
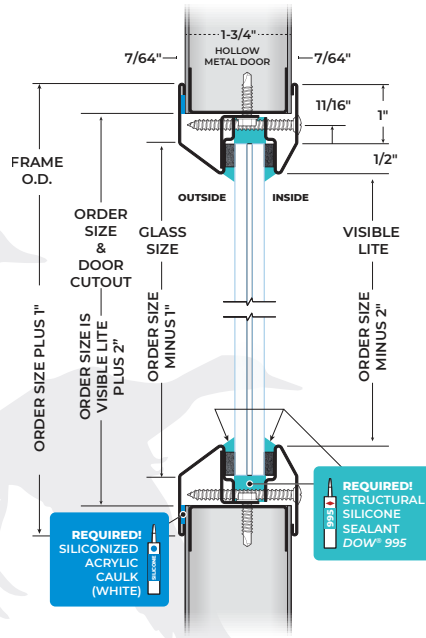
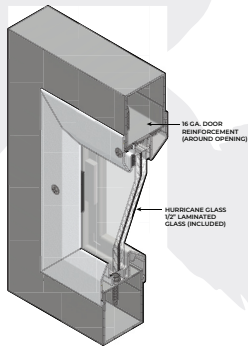

## INSTALL STORM-PRO-HR LITE KIT

### 1. The installation of the Storm-Pro-HR must comply with both the Storm-Pro-HR instructions and the door manufacturer's listing procedure.

For best results, install the Storm-Pro-HR with the door in a horizontal /flat (uninstalled) position.

### 2. Cutout Preparation:

- Create the cutout opening in the door for the Storm-Pro-HR and reinforce completely with 16 Ga. channels.
- Cutout size must match the order size of the Storm-Pro-HR.

### 3. Cleaning Preparation:

Thoroughly clean the vision frame and glass pocket area on both halves of the frame using a 50/50 mixture of isopropyl alcohol and water (not provided).

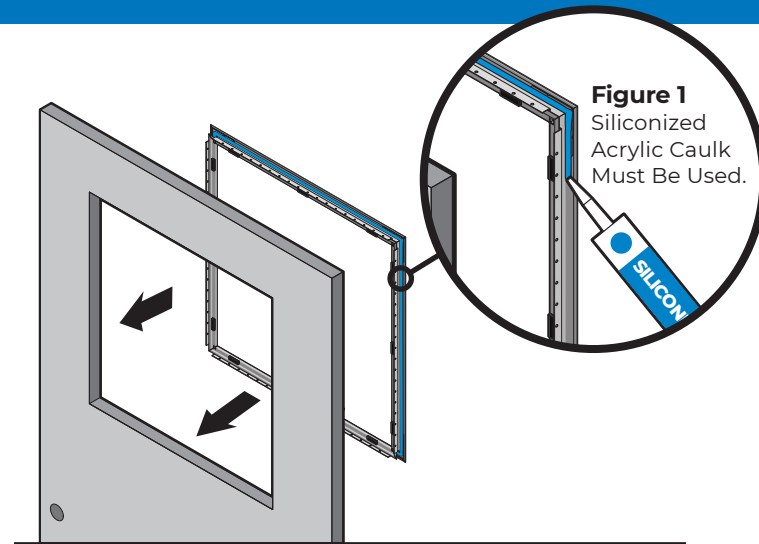

### 4. Exterior Frame Installation

- The exterior frame is the side without screw holes (mounting screws will be on the interior side of the door).
- Apply white siliconized acrylic caulk (provided in the Storm-Pro-HR kit) to the inside face of the exterior frame, ensuring full perimeter coverage inside the hemmed edge (Figure 1).

**NOTE: THIS IS NOT THE DOW® 995 CAULK, WHICH WILL BE USED IN A LATER STEP.**

- Insert the frame into the cutout, ensuring it sits flush with the exterior face of the door.
- Fasten the Storm-Pro-HR to the door cutout reinforcement channel using the #8 x 3/4" fasteners provided.
- The location and number of fasteners depend on the cutout size.

SIZE OF THE CUTOUT SIDE	FASTENERS	LOCATION
Up to 18"	1 Fastener	Centered
18" to 36"	3 Fasteners	3" From Each End, Centered
Over 36"	5 Fasteners	3" From Each End, Equally Spaced

(Continued on the back)

# INSTALLATION INSTRUCTIONS

# INSTALLATION INSTRUCTIONS

(Continued from the front)

## INSTALL STORM-PRO-HR LITE KIT

### 5. Glass Installation

- Ensure the glass identification etch ("bug") is positioned in the bottom right corner of the Storm-Pro-HR lite kit assembly, as viewed from the exterior side.
- Place the glass over the setting blocks on the exterior frame side, ensuring it is evenly spaced between the edge of the glass and the cutout (**Figure 2**).
- Apply Dow® 995 Structural Silicone Sealant (provided) between all edges of the glass and the reinforcement channel.

**Do not apply Dow® 995 over screw pilot holes.**

### 6. Interior Frame Installation

- Position the interior frame over the glass, ensuring the setting blocks remain in place during handling.
- Insert and start all screws (#8 x 1-3/4" fasteners provided).
- Tighten screws in a crisscross pattern, taking care not to strip the material or damage the glass. *Use caution when using power screwdrivers to prevent over-tightening.*

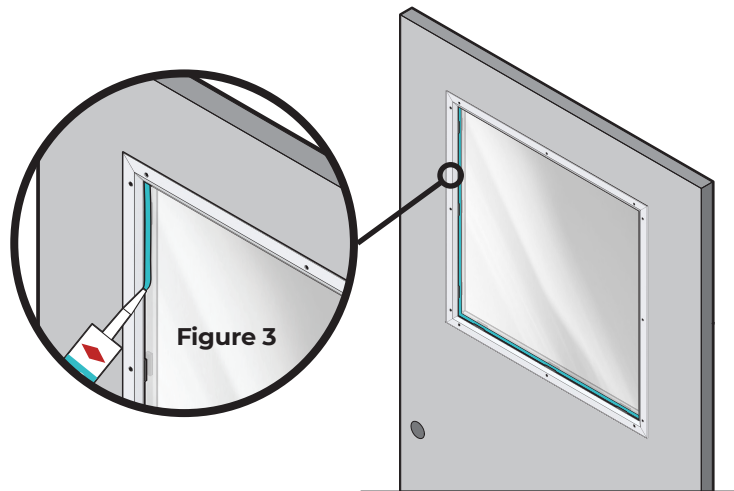
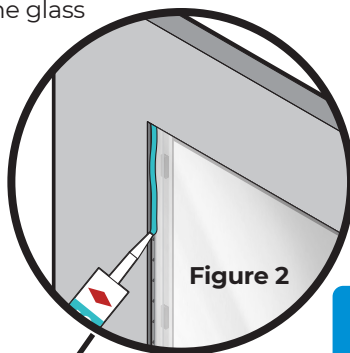
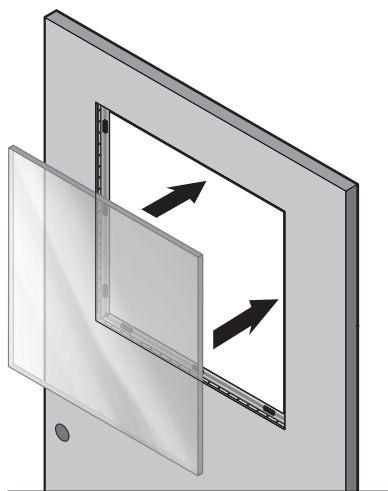

### 7. Structural Silicone Sealant Application

- Apply Dow® 995 Structural Silicone Sealant (provided) between the glass and frame on both sides (**Figure 3**).
- Refer to and follow the manufacturer's installation instructions for proper application and tooling techniques.

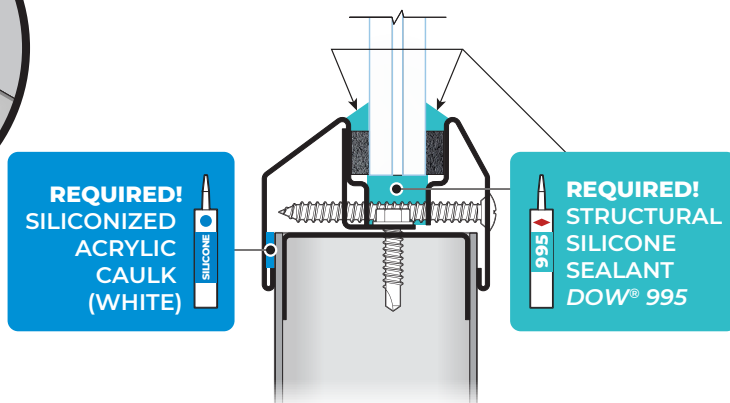

### DOW® 995 CURE TIMES:

Working/Tooling time	10-20 Minutes
Tack-free Time	45 Minutes
Handling Time	Allow To Cure For 24 Hours Before Handling
Full Cure	14-21 Days