

Markar 1000 Series Aluminum Pin & Barrel Continuous Hinges

Short Form Architectural Specification:

Continuous hinges shall be full height piano-type hinge providing full height door support.

- Supports weights up to 600 lbs. 4'0" maximum door width
- Material to be extruded aluminum 6063-T6 alloy
- .250" diameter stainless pin (rod)
- Each knuckle 4", including nylon bearing at each separation for a quiet, smooth, self-lubricating operation
- Finish: Clear Anodized (628)
Optional Finish: Light Bronze Anodized (311), Dark Bronze Anodized (313) Black Anodized (315), Scratch-Resistant Powder Coated Paint. Other finishes available upon request.
- All hinges shall be furnished with manufacturer's recommended hardware pack per specific model application
- Exterior barrel diameter .750" (3/4")
- Hinges certified ANSI/BHMA Standard A 156.26 Grade 1
- Symmetrically templated hole pattern

NOTE: 25-Year Warranty on all Continuous Pin & Barrel Hinges

Markar DSH1000 Double Swing Hinge

Standard Features

Barrel Type Hinge

.250" diameter stainless steel pin (rod)

Medical bearings

Material

6063-T6 aluminum alloy

Finishes

Clear Anodized (628)

Standards

ANSI/BHMA Standard A156.26 Grade 1

Mounting Hardware

12-24 x 11/16" Torx Flat

Head Undercut TEK Screws

#12-8 Torx Flat Head Particle

Board Screw

Capacity

Supports weights up to 600lbs. 4'0" maximum door width

Standard Sizes

7'0", 8'0"

Hole Pattern

Symmetrically templated

Handing

Handing not required

CMS Compliant

Eliminating additional ligature points ensures compliance for reimbursement through CMS (Centers for Medicare and Medicaid Services)

Optional Features

Finishes

Light Bronze Anodized (311)

Dark Bronze Anodize (313)

Black Anodized (315)

Scratch-Resistant Powder Coated

Paint

Other Features

Custom lengths - specify in inches

Custom hole pattern

Electrical Modifications

ElectroLynx®

SER4 (4 wire), SER8 (8 wire), SER12 (12 wire)

This door edge mounted aluminum pin & barrel type hinge has a unique feature that allows the door to swing in either direction up to 100°. When used in conjunction with Pemko Emergency Release Stop (ERS) provides an anti-barricade system

The Double Swing Hinge and Emergency Release Stop are accepted by the New York State Office of Mental Health (OMH) for use in high risk areas.

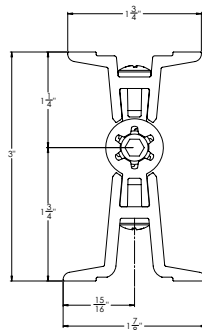

Door Closed

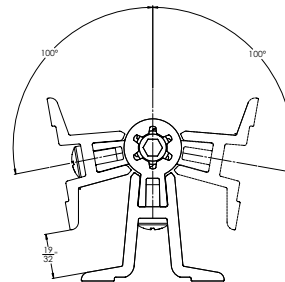

Door Open 100° Either Direction

ASSA ABLOY

The global leader in
door opening solutions

800-824-3018 | www.assaabloydooraccessories.us

Check the web site for the up-to-date catalog

Copyright © 2015-2018, Pemko Manufacturing Co., an ASSA ABLOY Group company. All rights reserved. Reproduction in whole or in part without the express written permission of Pemko Manufacturing Co. is prohibited.